

# 2017 EXHIBITOR FLYER

TEXAS PAIN SOCIETY'S 9TH ANNUAL

# EXPO & TRADESHOW

Krista R. DuRapau  
 Phone: 512-535-0010, Fax: 866-235-2557  
 kdurapau@texaspain.org

OCTOBER 27-29, 2017 • HYATT REGENCY DALLAS • DALLAS, TX

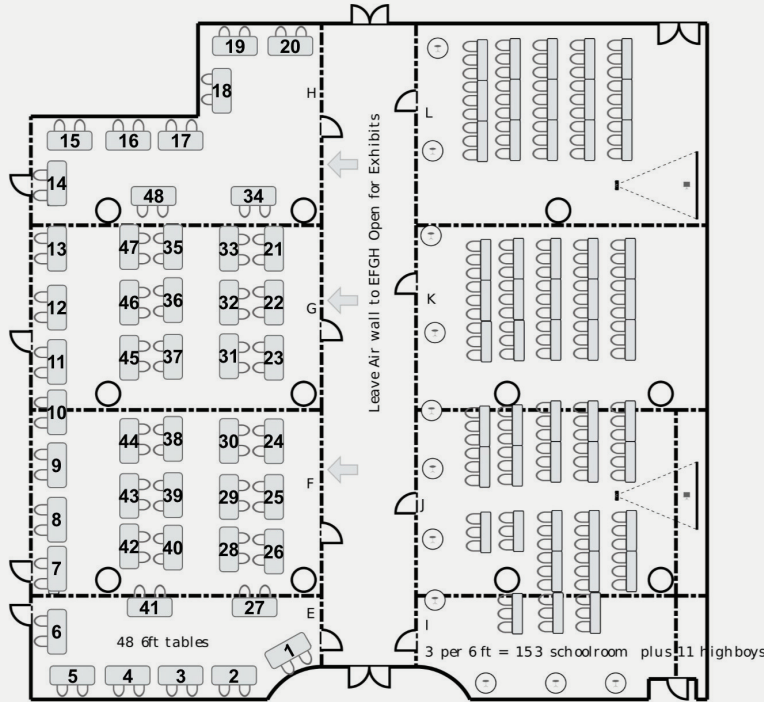

**EXHIBIT DATES**  
 October 27-29, 2016

**LOCATION**  
 Hyatt Regency Dallas  
 300 Reunion Blvd  
 Dallas, TX 75207

Exhibit Hall will be in on  
 Exhibition Level, Cumberland I,  
 J, K, L

**EXPECTED ATTENDANCE: 185+**

## 2016 EXHIBITOR LIST

- |                                |  |
|--------------------------------|--|
| Afferent Provider Solutions    | Medical Pillars Diagnostics                        |
| AIS Pain Care                  | MedShopTotal Care Pharmacy                         |
| Alere                          | Medtronic  |
| Allergan                       | Memorial Hermann Prevention<br>and Recovery Center |
| AstraZeneca (Daiiehi Sankyo)   | Nevro  |
| Boston Scientific              | NextHealth   |
| Cellarion                      | Nuvectra   |
| Celling Biosciences            | Pentec Health                                      |
| Collegium Pharmaceutical, Inc. | Pernix   |
| Cosman Medical                 | Precision Diagnostics                              |
| Depomed                        | Primus   |
| Disc Disease Solutions Inc     | Prove Bioscience                                   |
| Epimed International Inc.      | Purdue Pharma                                      |
| Flowonix Medical               | Recept Pharmacy                                    |
| Genotox Labs                   | Sentyln Therapeutics, Inc.                         |
| Harlee Medical Technologies    | SI-BONE  |
| Haylard Health                 | St. Jude   |
| Jazz Pharmaceuticals           | Vertos   |
| Kaleo Pharma                   | WatersCorp   |

## 2017 EXHIBITOR SHOW QUICK FACTS

### SHOW TIMES

#### FRIDAY, 10/27/2017

- Noon – 12:45pm .....Exhibit Hall Opens
- 3:00pm – 3:30pm .....Dedicated break in exhibit hall
- 6:00pm – 7:00pm .....Welcome Reception in exhibit hall

#### SATURDAY, 10/28/2017

- 8:00am – 8:30am .....Dedicated break in exhibit hall
- 9:45am – 10:15am .....Dedicated break in exhibit hall
- 12:30pm – 1:00pm .....Dedicated break in exhibit hall
- 2:00pm – 2:30pm .....FINAL break and prize  
drawings in exhibit hall

### SET UP TIMES

**THURSDAY, 10/26/2017** .... 12:00pm – 5:00pm

**FRIDAY, 10/27/2017** ..... 7:00am – 11:30am

### TEAR DOWN TIMES

**SATURDAY, 10/28/2017** .... 2:30pm – 6:00pm

*\*No exhibits on Sunday 10/29/2017\**